

REFERENCE DRAWINGS	
DRG. No.	DESCRIPTION
-	-
-	-
-	-
-	-
-	-
-	-
-	-
-	-
-	-
-	-

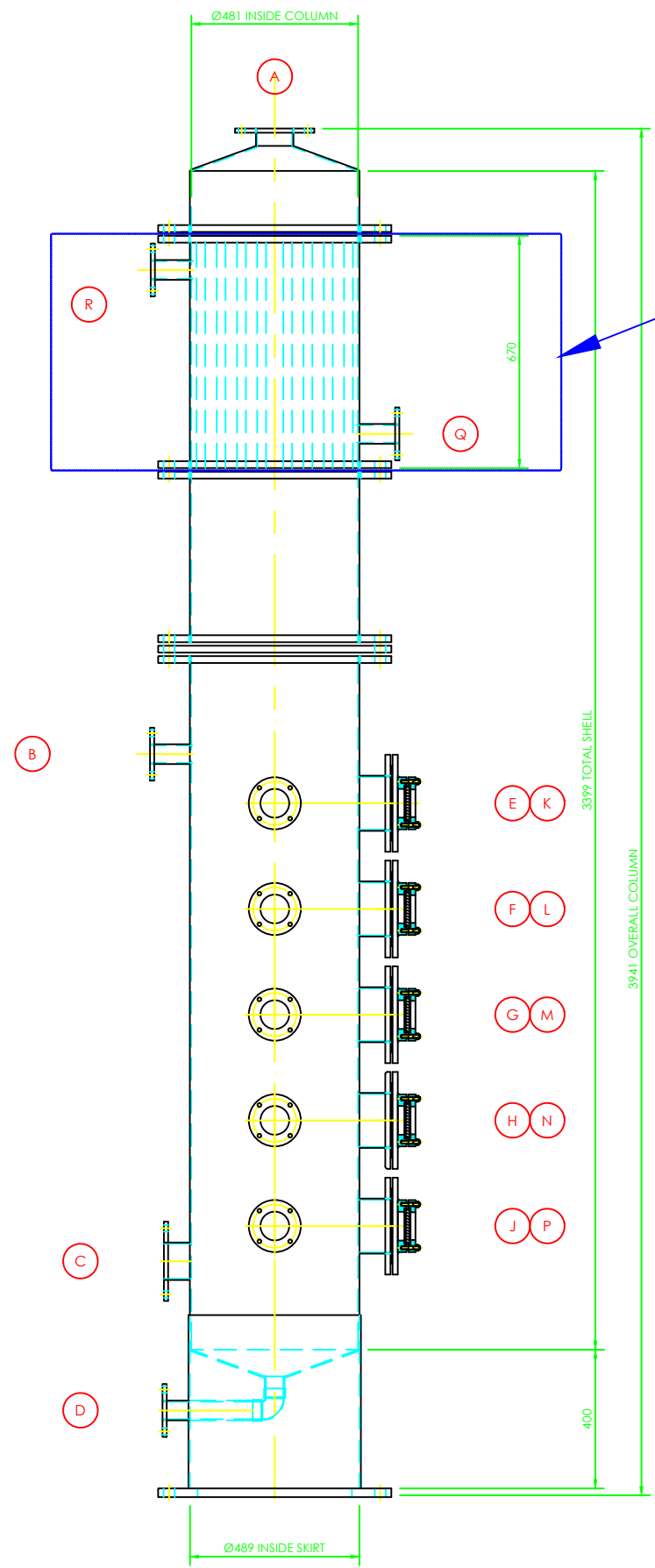

NEW DEPHLAGMATOR SECTION

ELEVATION VIEW
SEE PLAN VIEW FOR TRUE NOZZLE ORIENTATIONS

REF.	NPS	SERVICE	CLASS	TYPE	NECK	REMARKS
A	4"	VAPOUR OUTLET	ASA150#	PLATE	10SWG	-
B	2"	REFLUX RETURN INLET	ASA150#	PLATE	10SWG	-
C	4"	VAPOR INLET	ASA150#	PLATE	10SWG	-
D	2"	BOTTOMS OUTLET	ASA150#	PLATE	10SWG	-
E	6"	ACCESS HATCH	ASA150#	PLATE	10SWG	CW BLIND & SIGHT GLASS
F	6"	ACCESS HATCH	ASA150#	PLATE	10SWG	CW BLIND & SIGHT GLASS
G	6"	ACCESS HATCH	ASA150#	PLATE	10SWG	CW BLIND & SIGHT GLASS
H	6"	ACCESS HATCH	ASA150#	PLATE	10SWG	CW BLIND & SIGHT GLASS
J	6"	ACCESS HATCH	ASA150#	PLATE	10SWG	CW BLIND & SIGHT GLASS
K	4"	SIGHT GLASS	ASA150#	-	-	-
L	4"	SIGHT GLASS	ASA150#	-	-	-
M	4"	SIGHT GLASS	ASA150#	-	-	-
N	4"	SIGHT GLASS	ASA150#	-	-	-
P	4"	SIGHT GLASS	ASA150#	-	-	-
Q	2"	COOLING WATER INLET	ASA150#	PLATE	10SWG	-
R	2"	COOLING WATER OUTLET	ASA150#	PLATE	10SWG	-

REVISION HISTORY				
REV	DATE	DESCRIPTION	DRN	APP
01		FIRST ISSUE	SM	NB
02	21 SEPT 17	UPDATED WITH DEPHLAGMATOR	BN	NB
03	21 NOV 17	UPDATED WITH LARGER DEPHLAGMATOR	BN	NB

Forsyths established 1890
 ROTHES, MORAY
 AB38 7AD
 SCOTLAND
 TEL: +44 (0)1340 831 787 ; FAX: +44 (0)1340 831 558 ; E-MAIL: enquiries@forsyths.com

CLIENT:
 HIGH WEST DISTILLERY
 PARK CITY, UTAH, USA

TITLE:
 SPIRIT COLUMN
 GENERAL ARRANGEMENT

THIS DRAWING CONTAINS PROPRIETARY INFORMATION BELONGING TO FORSYTHS LTD. THE REPRODUCTION, DISTRIBUTION & COMMUNICATION OF ALL OR PART OF ITS CONTENTS TO OTHER PARTIES WITHOUT PRIOR WRITTEN CONSENT IS PROHIBITED.

C.A.D. PRODUCED DRAWING - DO NOT ALTER MANUALLY

ALL DIMENSIONS ARE IN MILLIMETRES

DO NOT SCALE - IF IN DOUBT, ASK

PROJECTION FIRST ANGLE

SCALE (A1) 1:10
 DRAWING NUMBER C3926-020
 REV 03